







# Installation

## Isolation valve and cabinet:

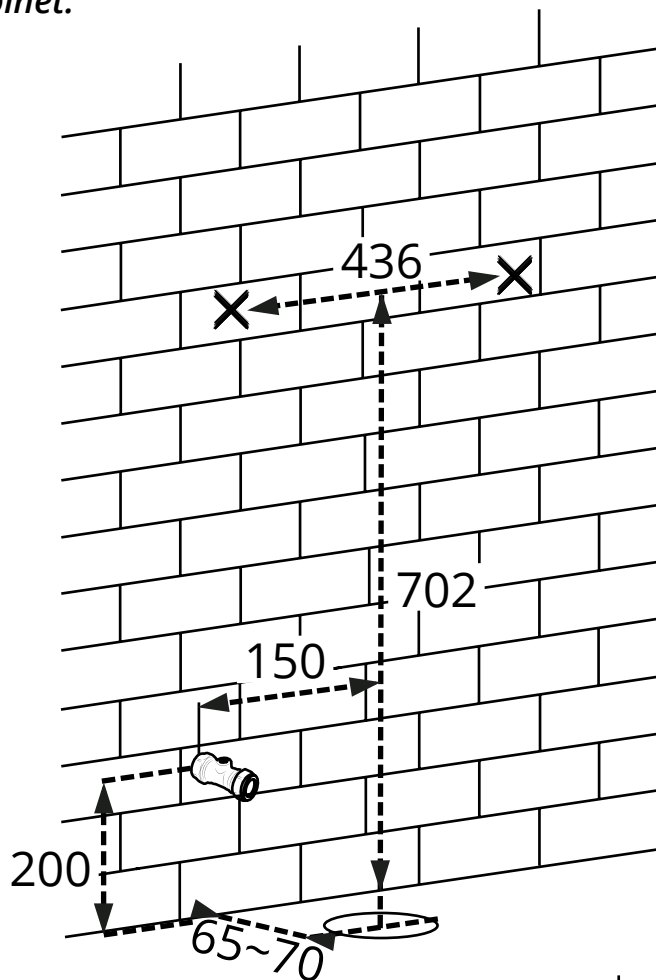

## Waste pipe:

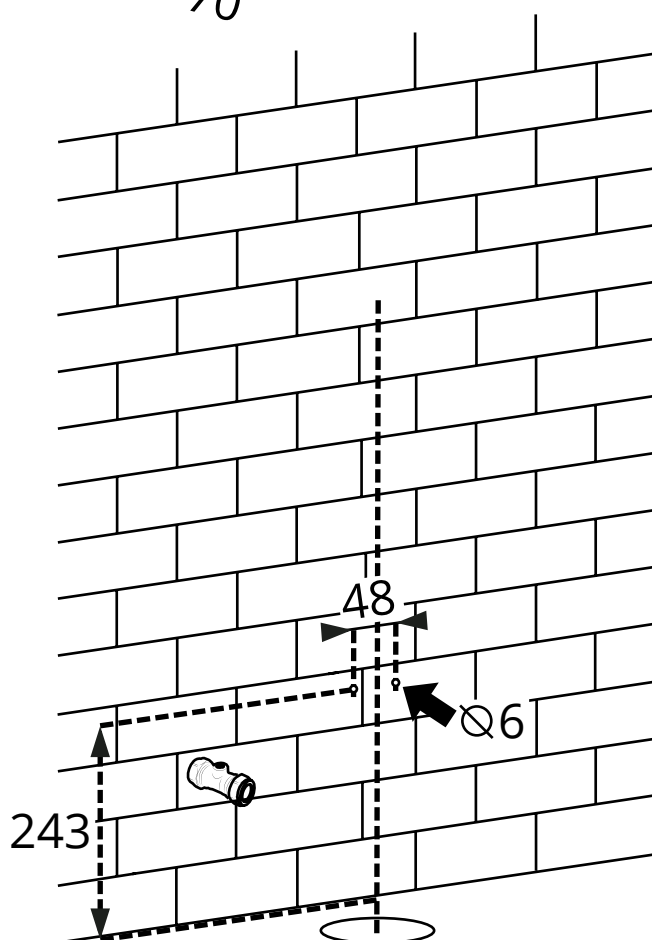

Installing the cabinet:

1

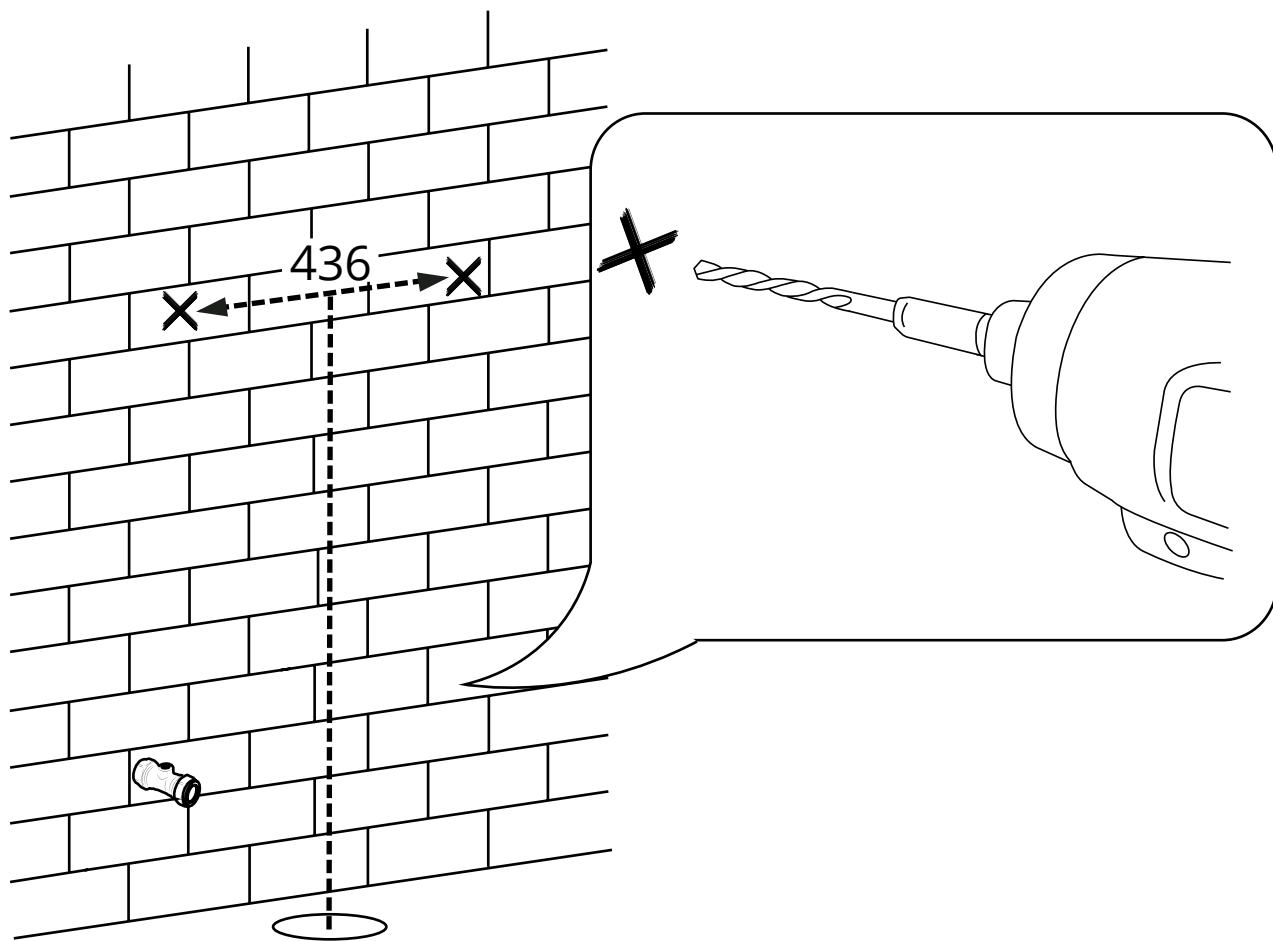

2

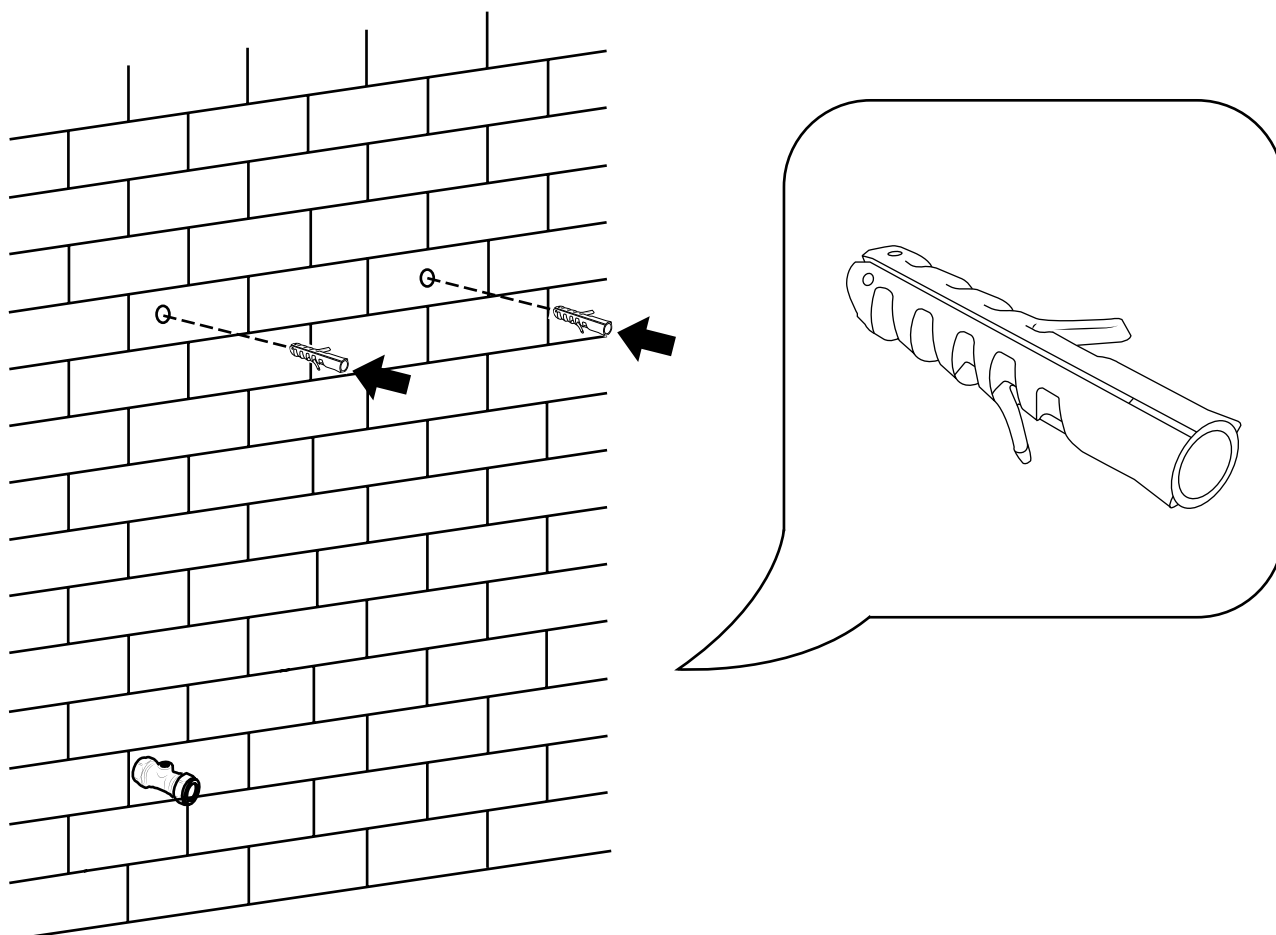

3

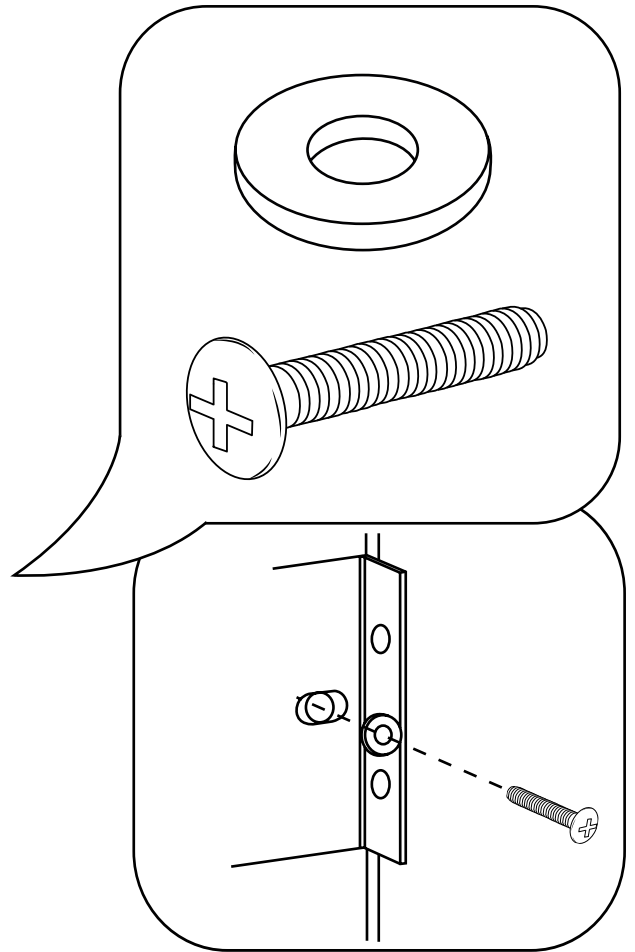
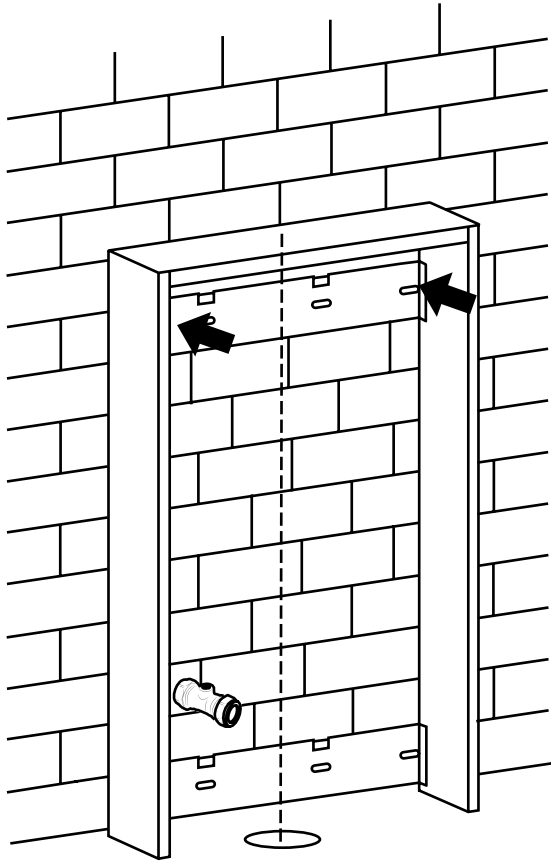

*Installing the 90° waste pipe:*

1

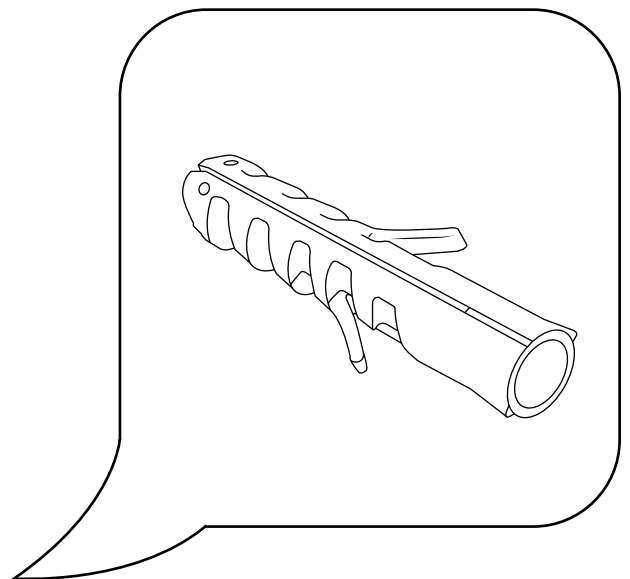
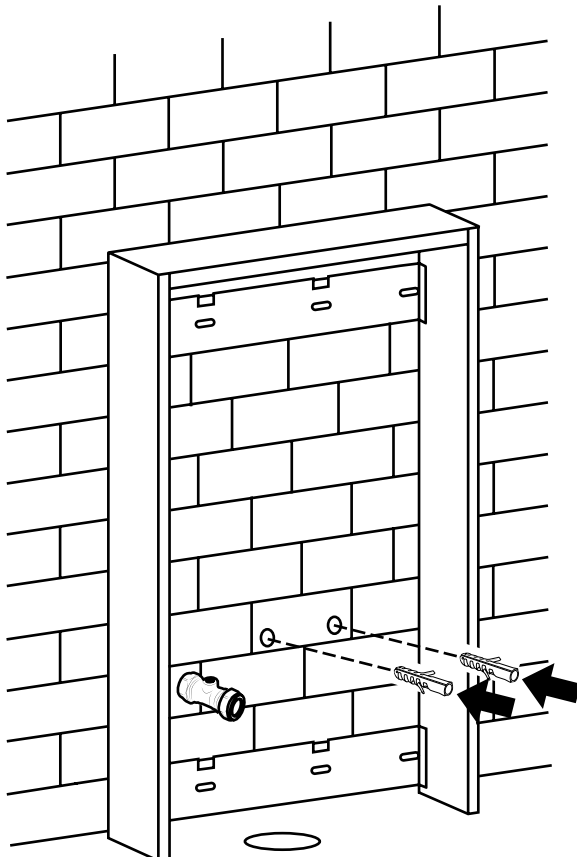

2

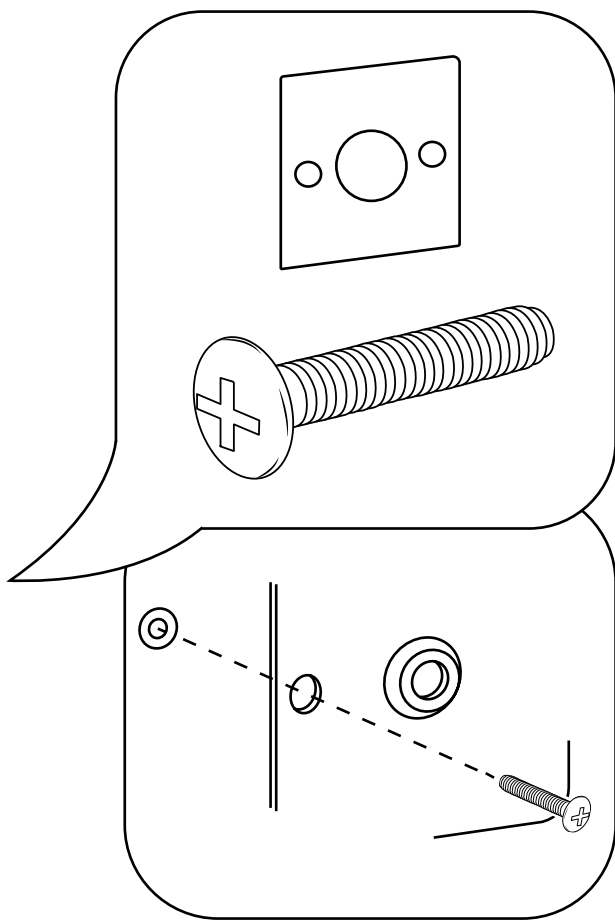
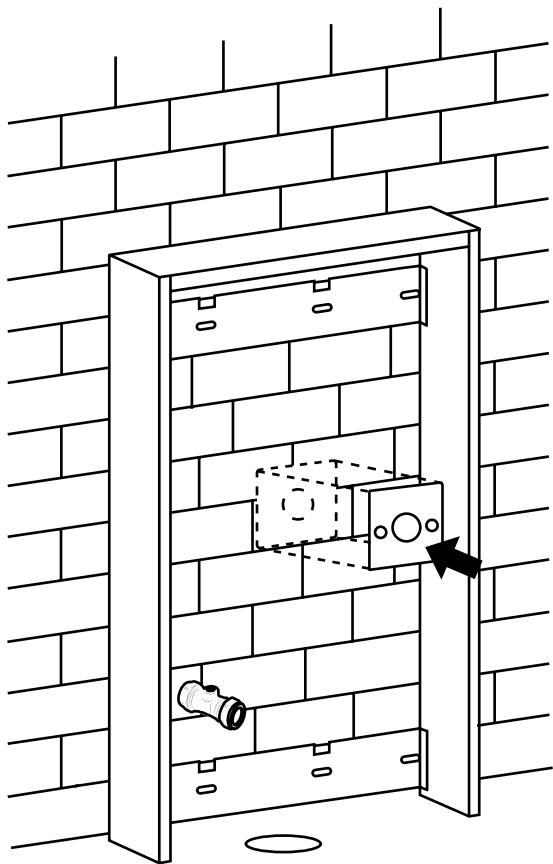

3

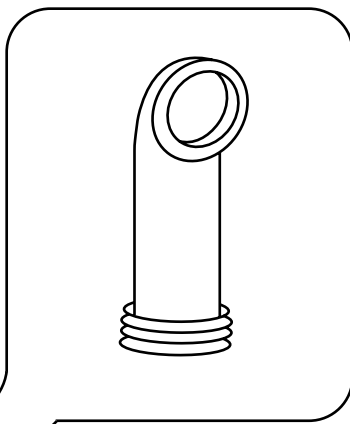
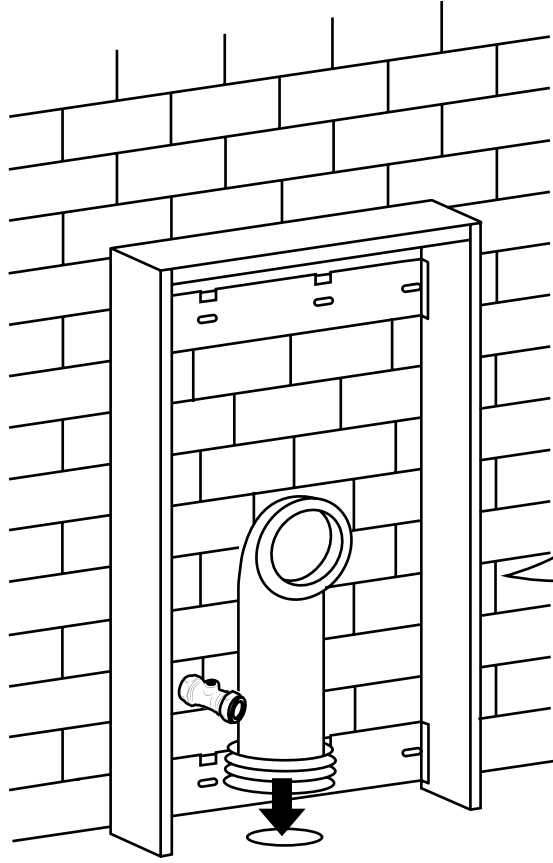

4

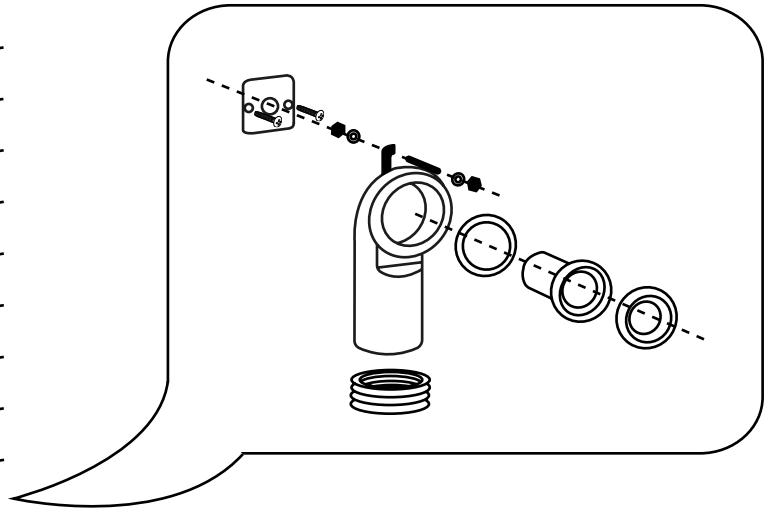
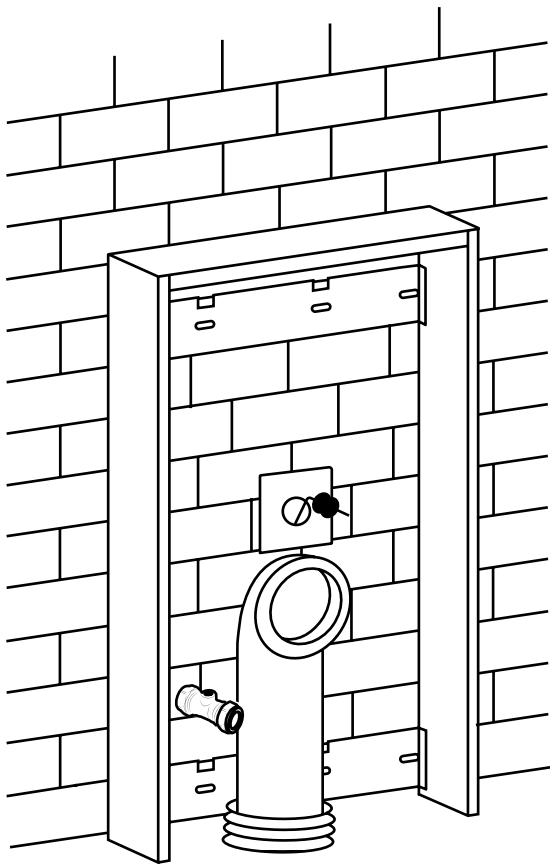

*Cutting the flush bend and waste pipe:*

1

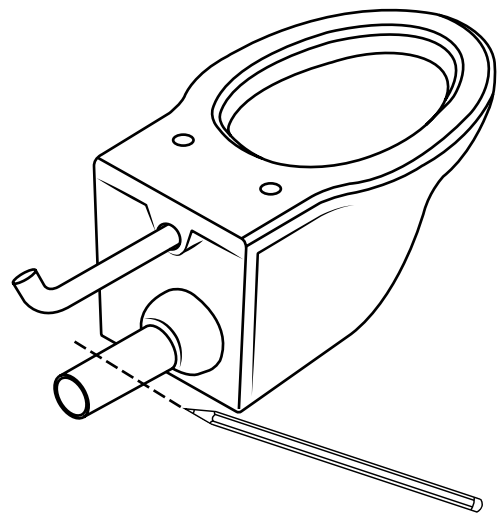
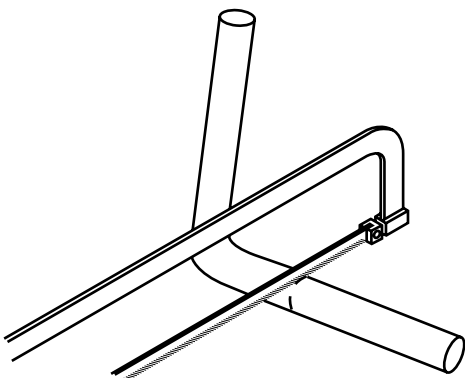

2

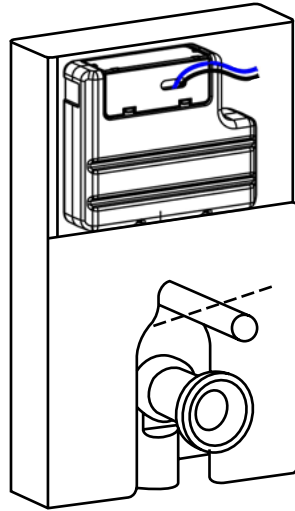

3

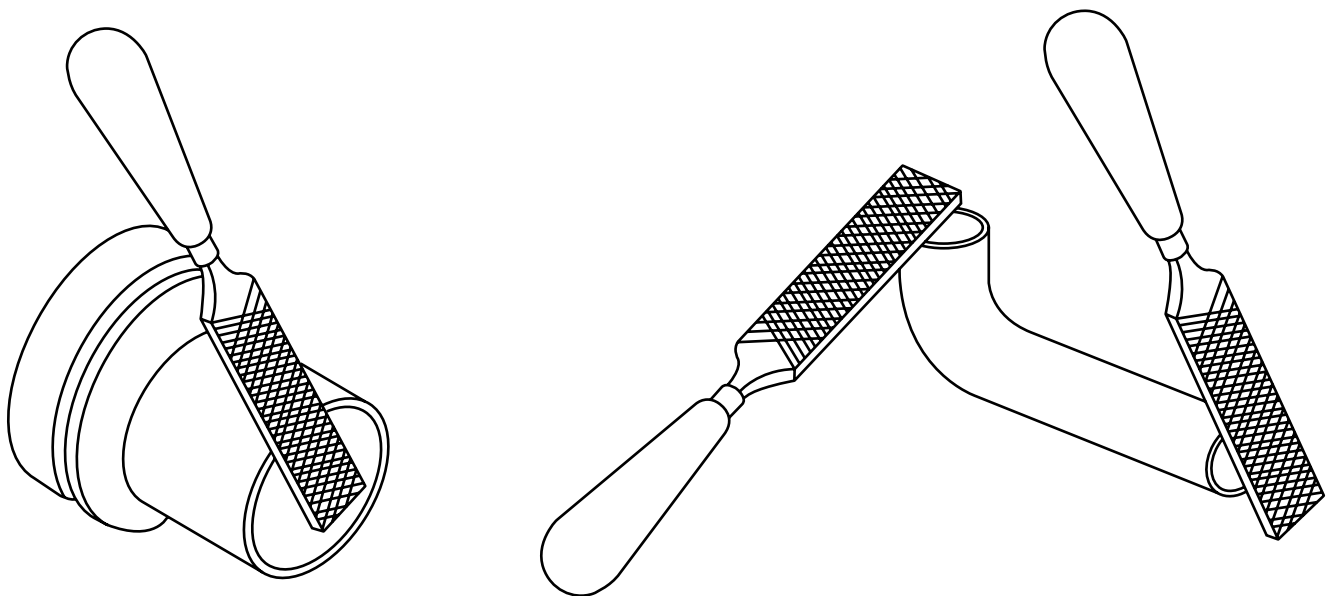

*Installing the cistern body:*

1

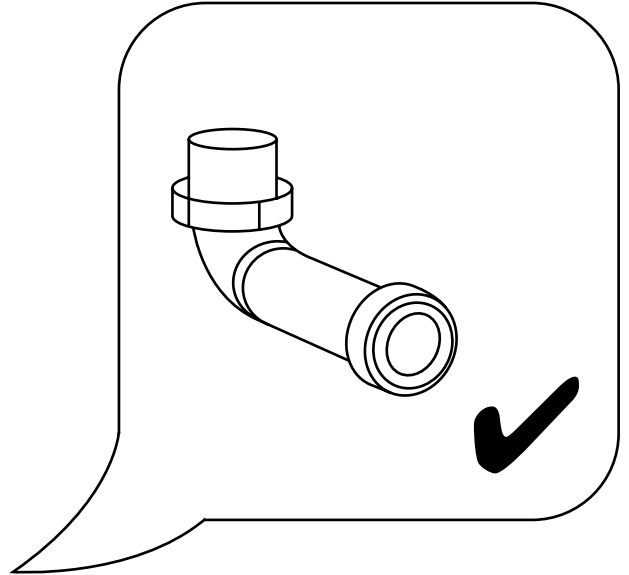
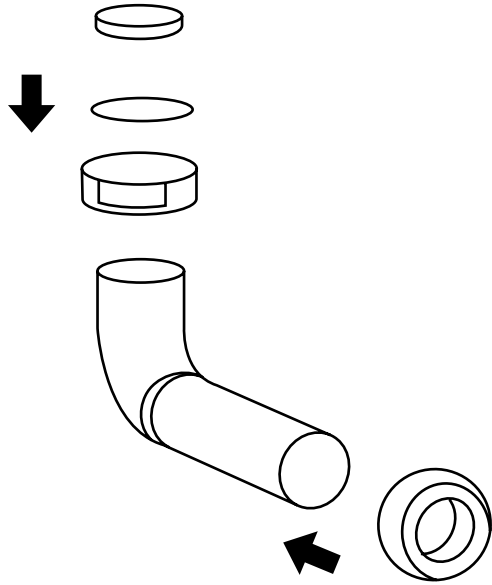

2

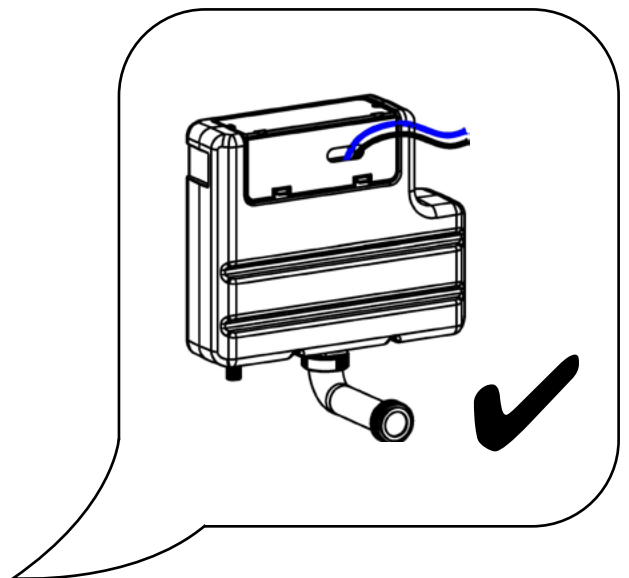
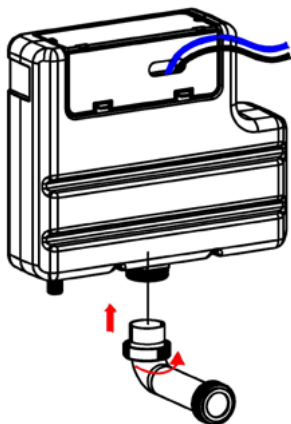

3

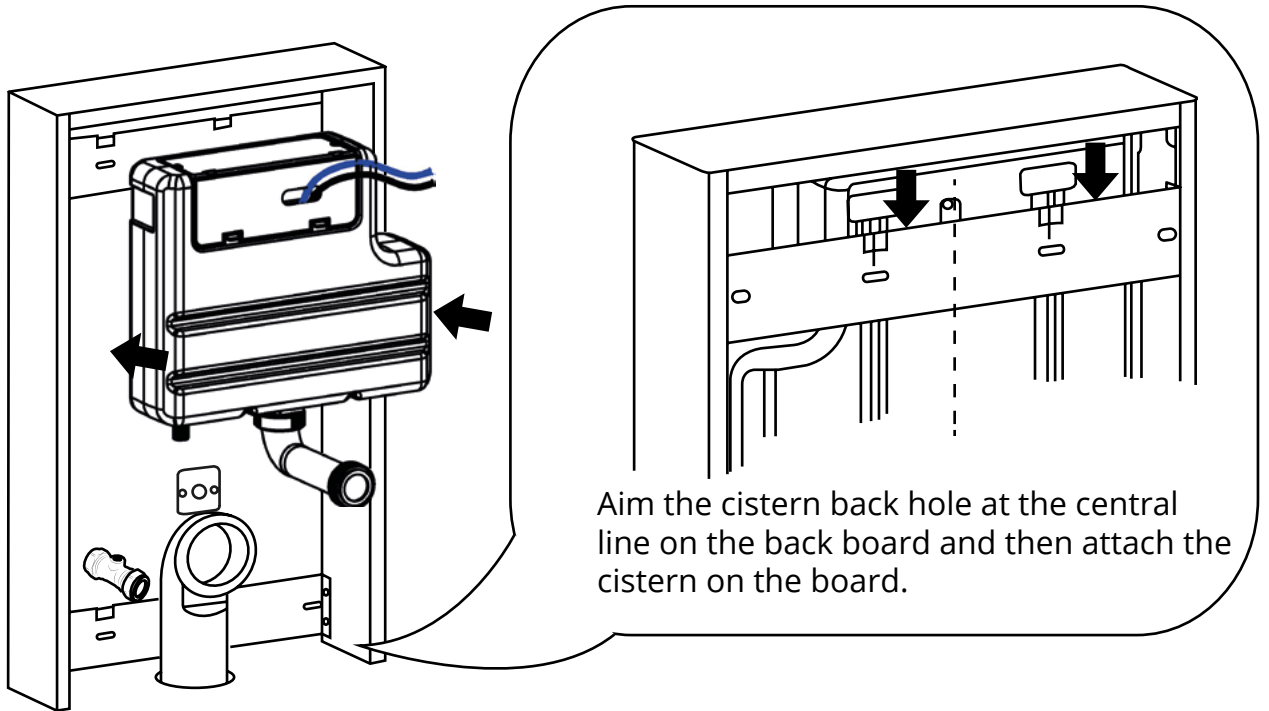

4

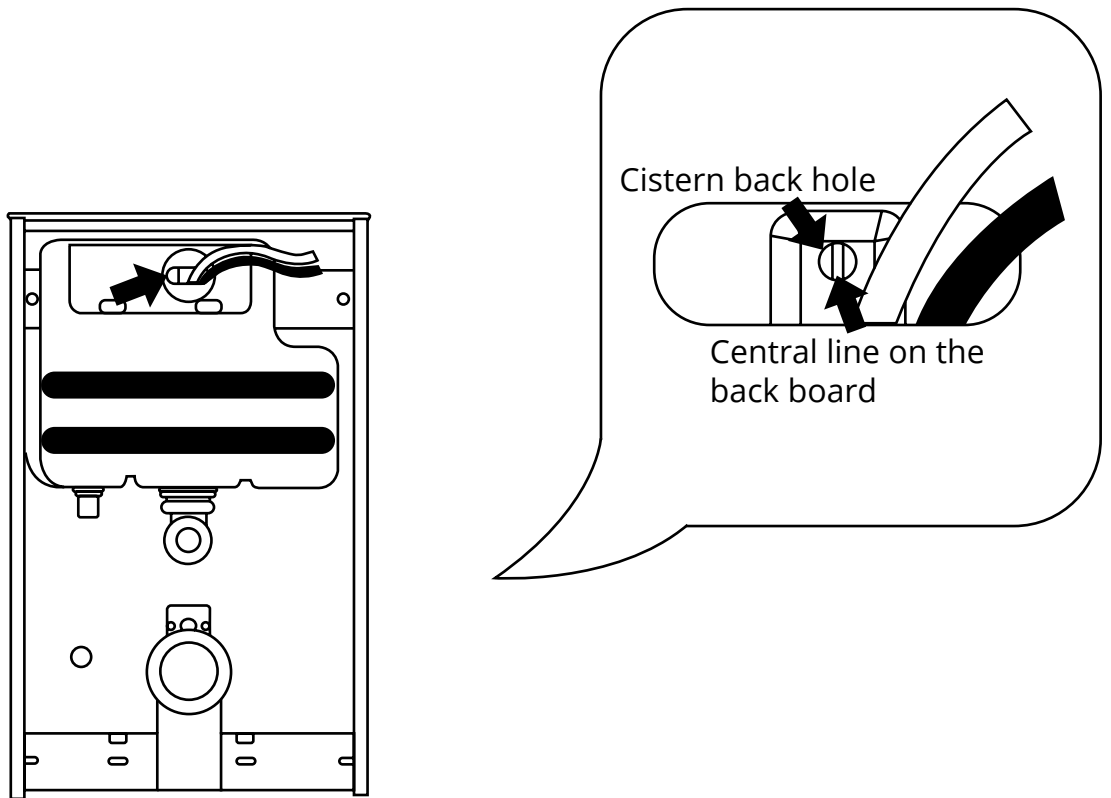

5

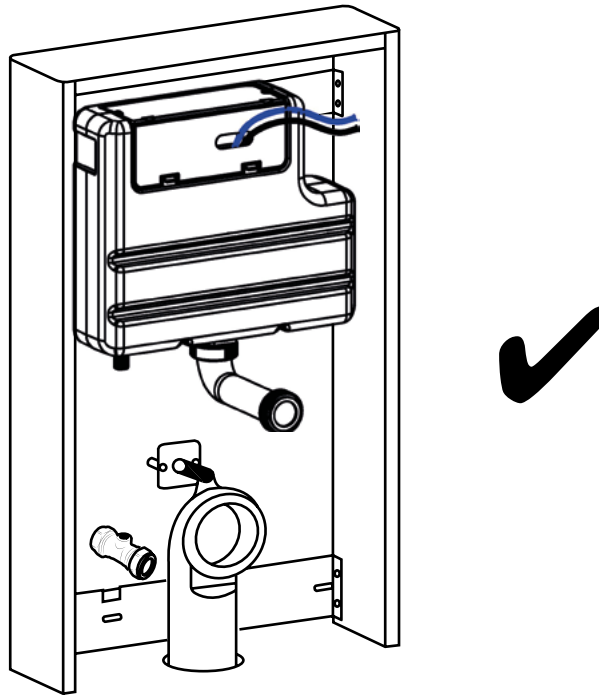

*Installing the water supply hose:*

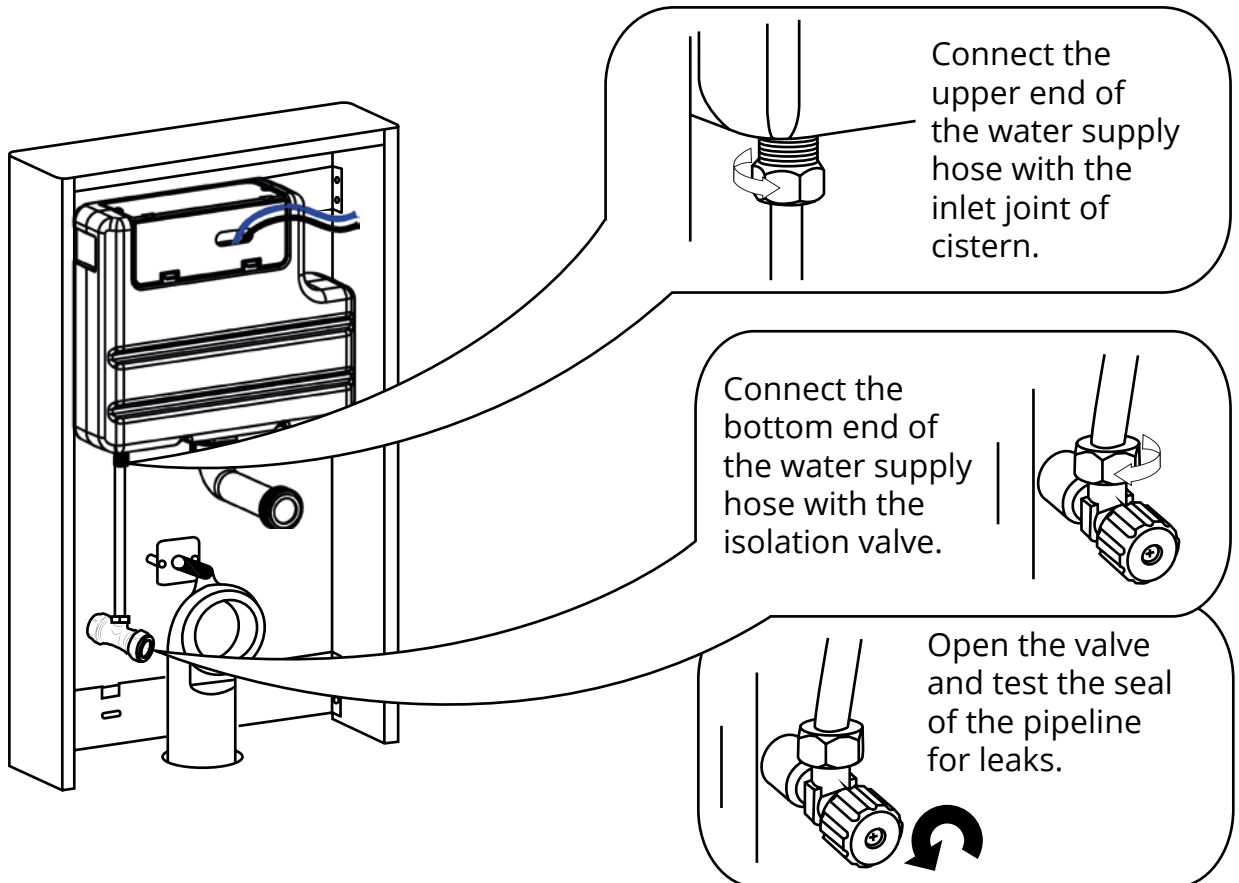

*Installing the bottom panel:*

1

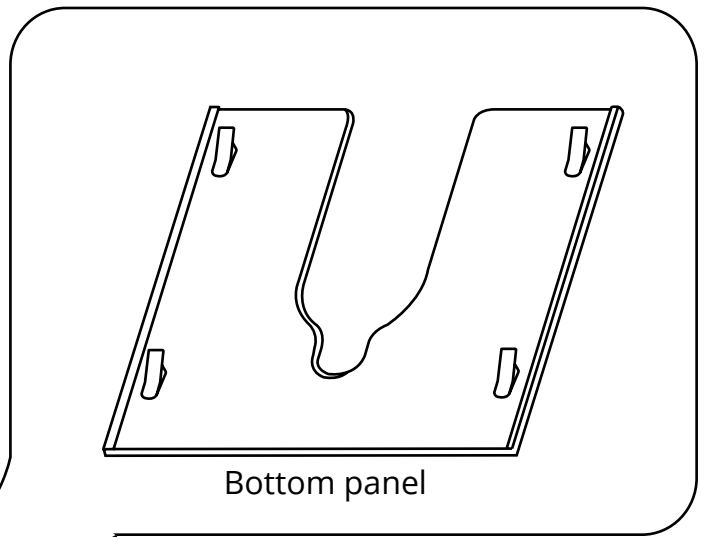
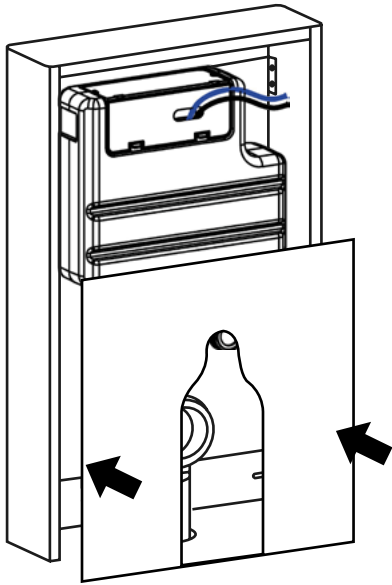

2

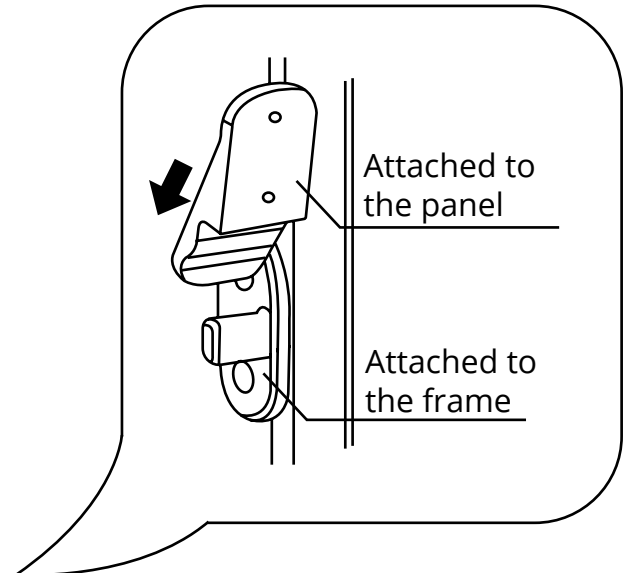
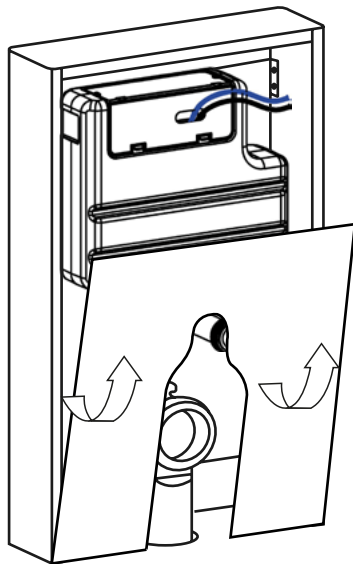

3

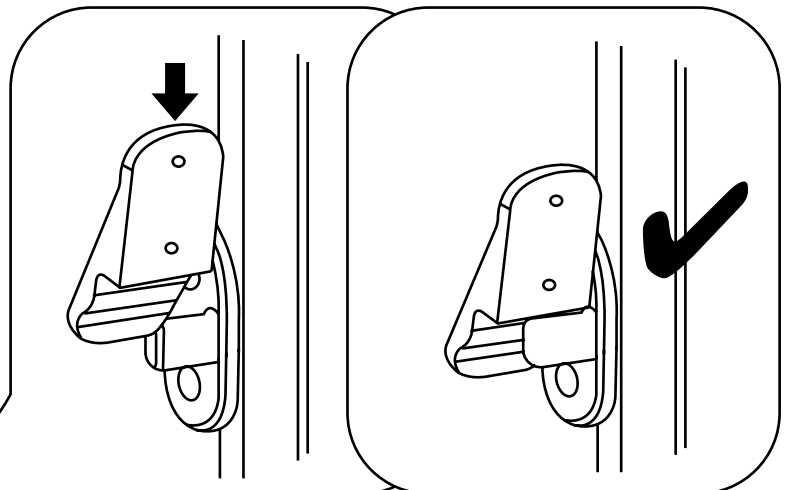
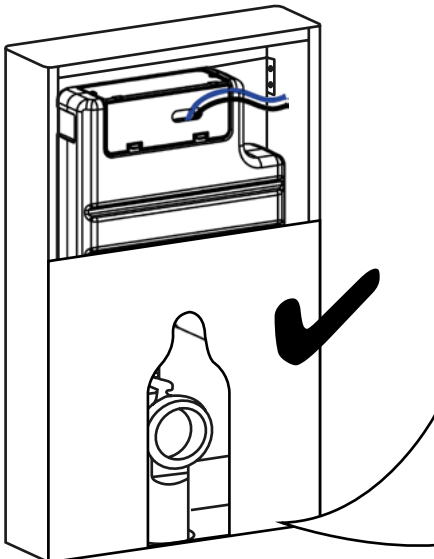

*Installing the push button:*

1

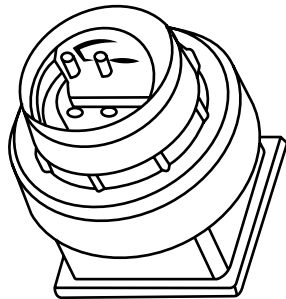

Loosen the nut

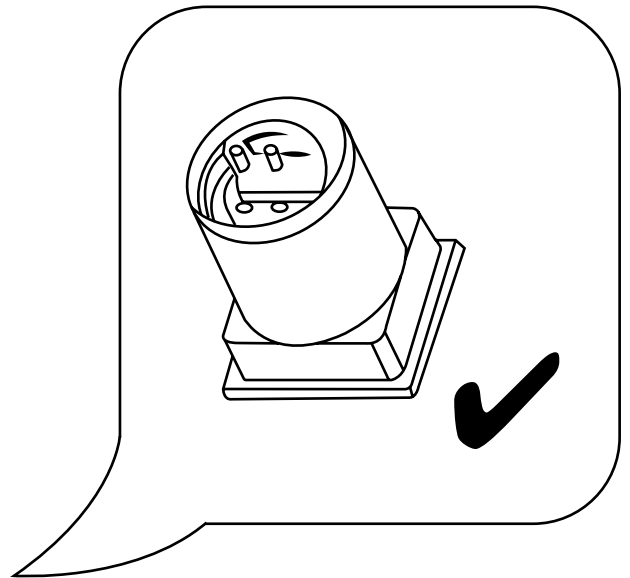

2

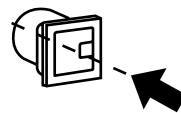
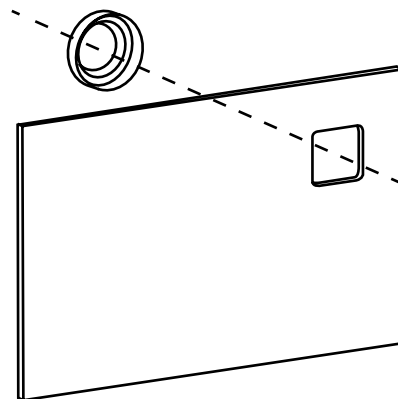

Install the push button

3

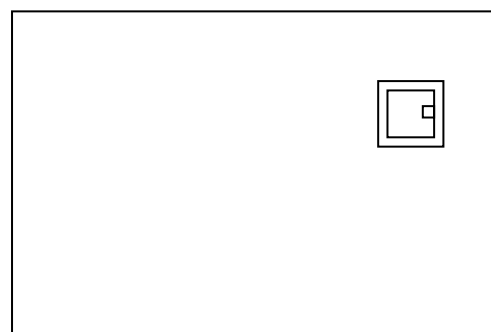
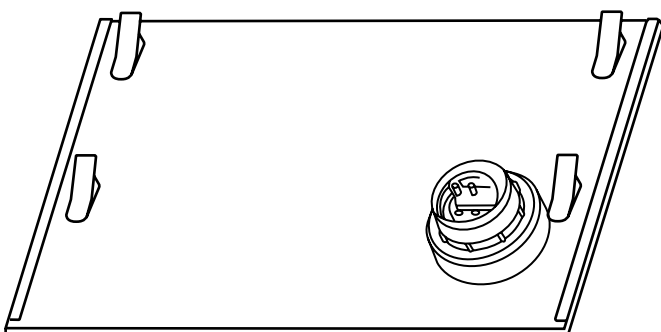

*Installing the upper panel:*

1

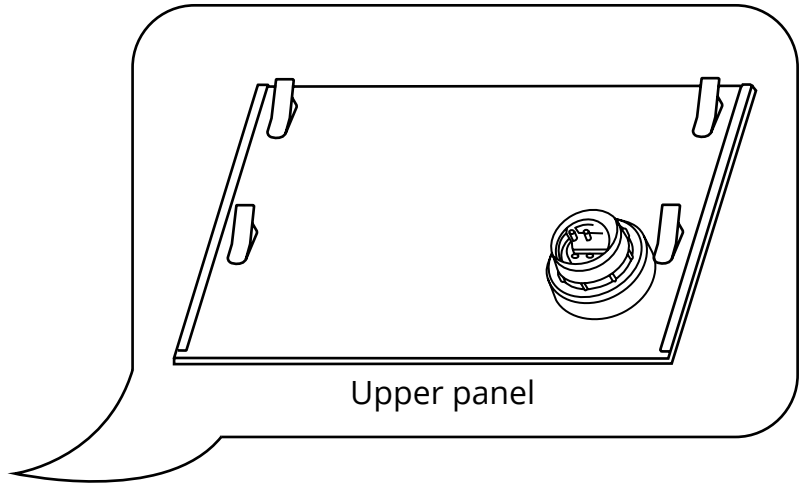
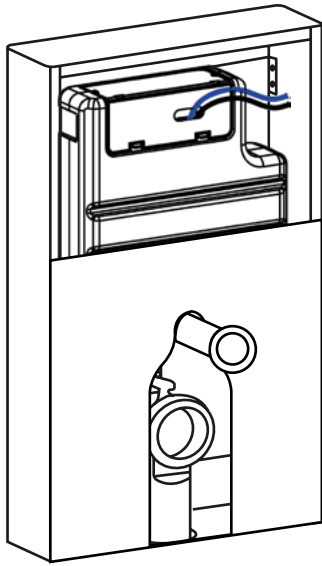

2

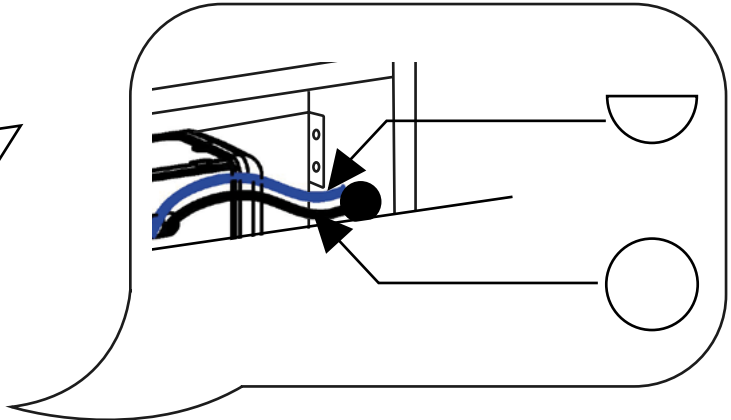
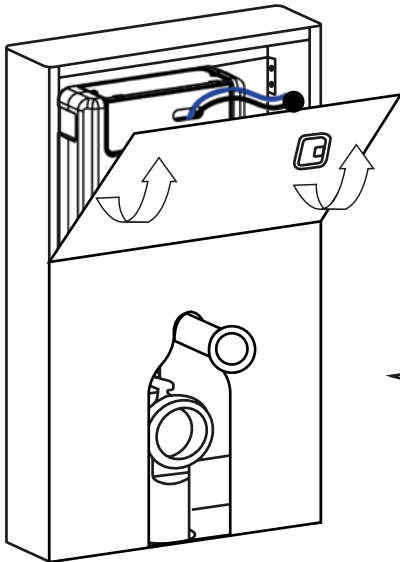

3

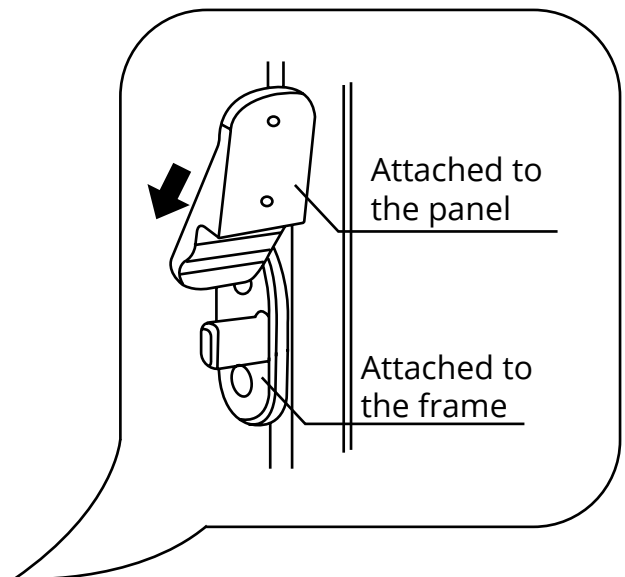
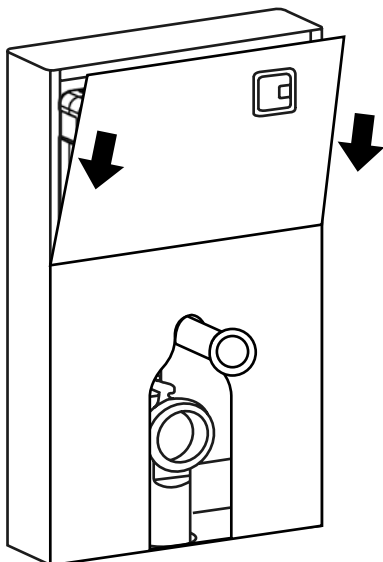

4

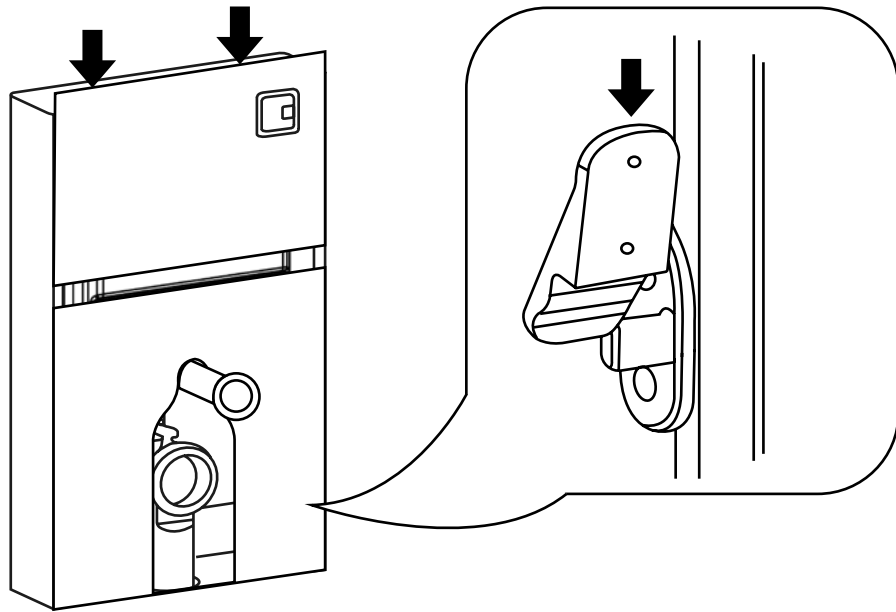

5

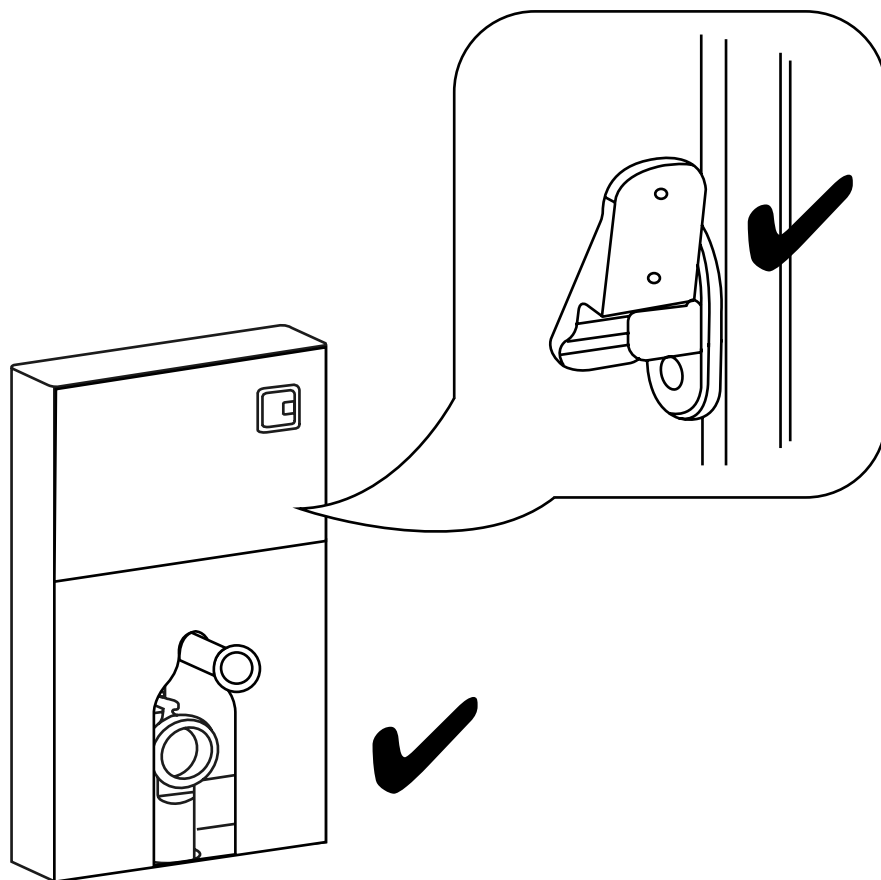

*Installing the pan:*

1

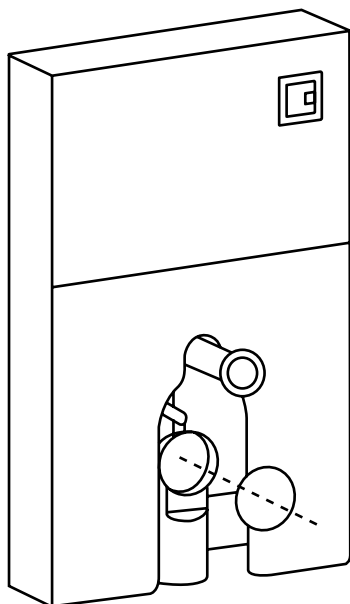

Fit the rubber connector into the 90° waste pipe.

2

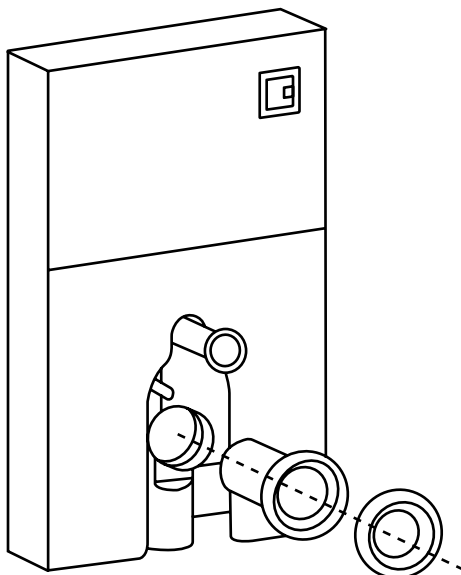

Install the waste pipe and the joint sleeve.

3

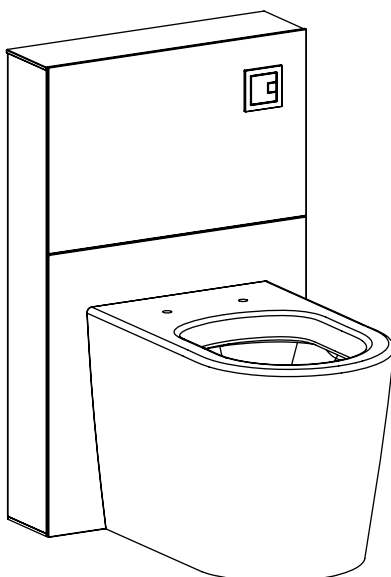

**i** Style may vary